

AROGETI RESIDENCE REPLANTING PLAN:

**AROGETI RESIDENCE PLANT SCHEDULE:**

QTY.	COMMON NAME	BOTANICAL NAME	SIZE	COMMENTS
6	'Kousa' Dogwood	<i>Cornus kousa</i>	2" Cal.	Single Straight Leader, Healthy, Good Form
5	'Greenleaf' American Holly	<i>Ilex opaca 'Greenleaf'</i>	5' Ht.	Full to Ground, Healthy, Good Form
2	'Pee Gee' Hydrangea	<i>Hydrangea paniculata 'Grandiflora' Pee Gee</i>	5 Gal.	Healthy, Good Form, Full in Pot
3	Oakleaf Hydrangea	<i>Hydrangea quercifolia</i>	3 Gal.	Healthy, Good Form, Full in Pot
7	'Vintage Jade' Distylium	<i>Distylium 'Vintage Jade'</i>	3 Gal.	Healthy, Good Form, Full in Pot
29	Dwf. Yaupon Holly	<i>Ilex vomitoria 'hانا'</i>	3 Gal.	Full in pot, Good Form, Healthy

**LANDSCAPE NOTES AND TREE PROTECTION NOTES**

- The site contractor shall contact the appropriate utility companies to have the locations of their underground utilities marked prior to beginning work. The contractor shall coordinate service routing of all gas, telephone, and electrical lines with the appropriate utility company. Caution shall be exercised to avoid interruption of services. The contractor is responsible for repair of all existing utilities damaged during construction. All construction must comply with each utility's standards and specifications and not interfere with tree planting sites or existing trees to be preserved.
- Trees, shrubs, ground cover, sod, seed, ornamental grasses and any other planted materials: Maintenance shall begin immediately after each plant is planted and shall continue until all plants are accepted by the Owner. The quantities shown in the plant schedule are solely for information of the contractor. The contractor shall verify the quantities shown in the plant schedule with the quantities shown on the planting plan. All differences in the quantities shall be brought to the attention of the Landscape Architect for clarification.
- Do not scale from the drawing.
- Final locations of all plant material shall be subject to the approval of the Owner's representative. Site adjustment of planting design and relocation of plant materials installed prior to Owner's representatives approval shall be done without additional cost or penalty to Owner.
- All plant materials shall conform with the latest edition of "American Standards for Nursery Stock" by the American Nursery and Landscape Association. All plant material shall meet or exceed the specifications of the Federal, state and county laws requiring inspection for disease and insect control. Botanical names shall take precedence over common names.
- Label at least one plant of each species with a securely attached water-proof tag bearing legible designation of Botanical and Common name for inspection.
- All planting pits shall be free of rocks, gravel and other debris. All planting pits shall be prepared in accordance with the planting details.
- Plant quality: All plants shall be sound, free of disease or pests and shall have a healthy normal root system.
- No substitution of plant species or variety shall be made without prior written permission from the Landscape Architect.
- Maintenance of plants shall include, but not necessarily be limited to, watering, spraying, mulching, pruning, mowing, fertilizing, etc. or other activities as directed by the Owner's representative.
- Final acceptance shall be granted by the Owner's representative upon completion of the entire project. The Contractor shall promptly make all replacements before, during and at the end of the guarantee period as directed by the Owner's representative.
- All planted shrubs and/or sod not included in the easement agreements shall be maintained by the property owner. This includes watering, fertilizing, pruning, etc. after installation.
- All plant material which dies, turns brown, or defoliates both prior to the final acceptance of the work and during the guarantee period shall be promptly removed from the site and replaced with material of the same species, variety, quantity, size and meeting all plant schedule specifications.
- Burlap material on balled and burlapped plants shall be the type which will decay within two years (no synthetics, plastic, nylon, treated or other non-natural types will be allowed). After setting balled and burlapped plants in the planting pit, all binder twine shall be cut and the burlap removed from the top 1/3 (one-third) of the rootball.
- All shrub, groundcover, tree ring and perennial bed areas shall be top dressed with a minimum depth of 2-3" of compacted mulch. The mulch shall be free from mold, sticks, cones, weeds and other debris. Compaction of the mulch shall occur naturally over a two week period during which at least one significant rainfall has occurred. Additional mulch shall be placed in order to maintain the minimum depth until date of final acceptance.
- Contractor shall spray trees and shrubs with anti-dessicant prior to transplanting and transporting if foliage is present. All plant material must be protected from wind by tarpaulin during shipment.
- The Owner's representative reserves the right to reject at any time until the end of the guarantee period any and / or all plant material that does not meet the specifications as set forth here and in the plant schedule.
- All plant materials shall be Grade A or better and planted as per the plant list, details and comments/notes.
- All plant materials (including sod) shall be properly watered immediately after installation. Water shall be applied at a rate that will completely saturate the rootball/roots regardless of weather conditions. If the height of the rootball is 24", then the plant shall be watered to a depth of 24".
- Contractor to provide irrigation design and installation per agreement with Owner.

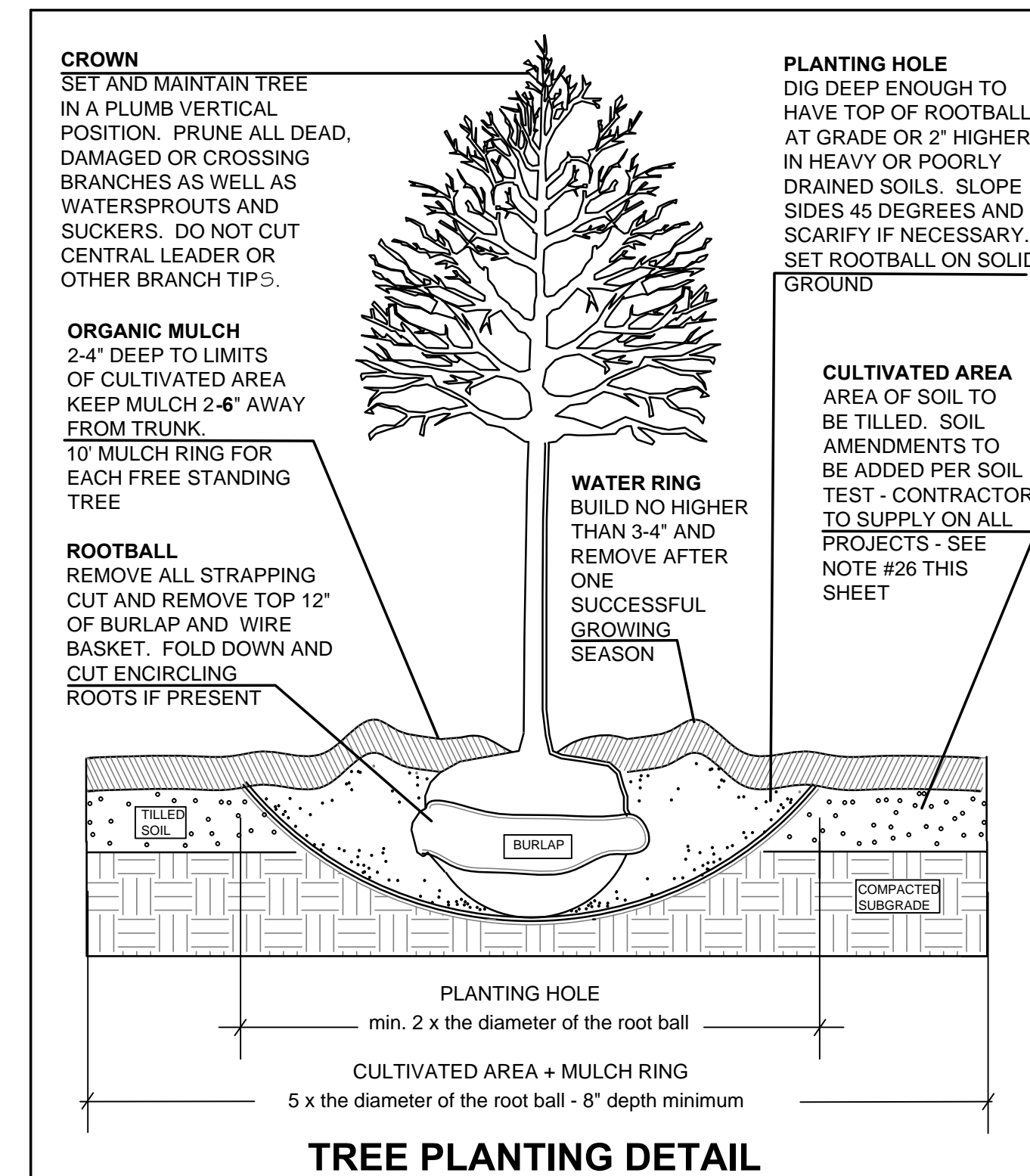

**TREE PLANTING DETAIL**

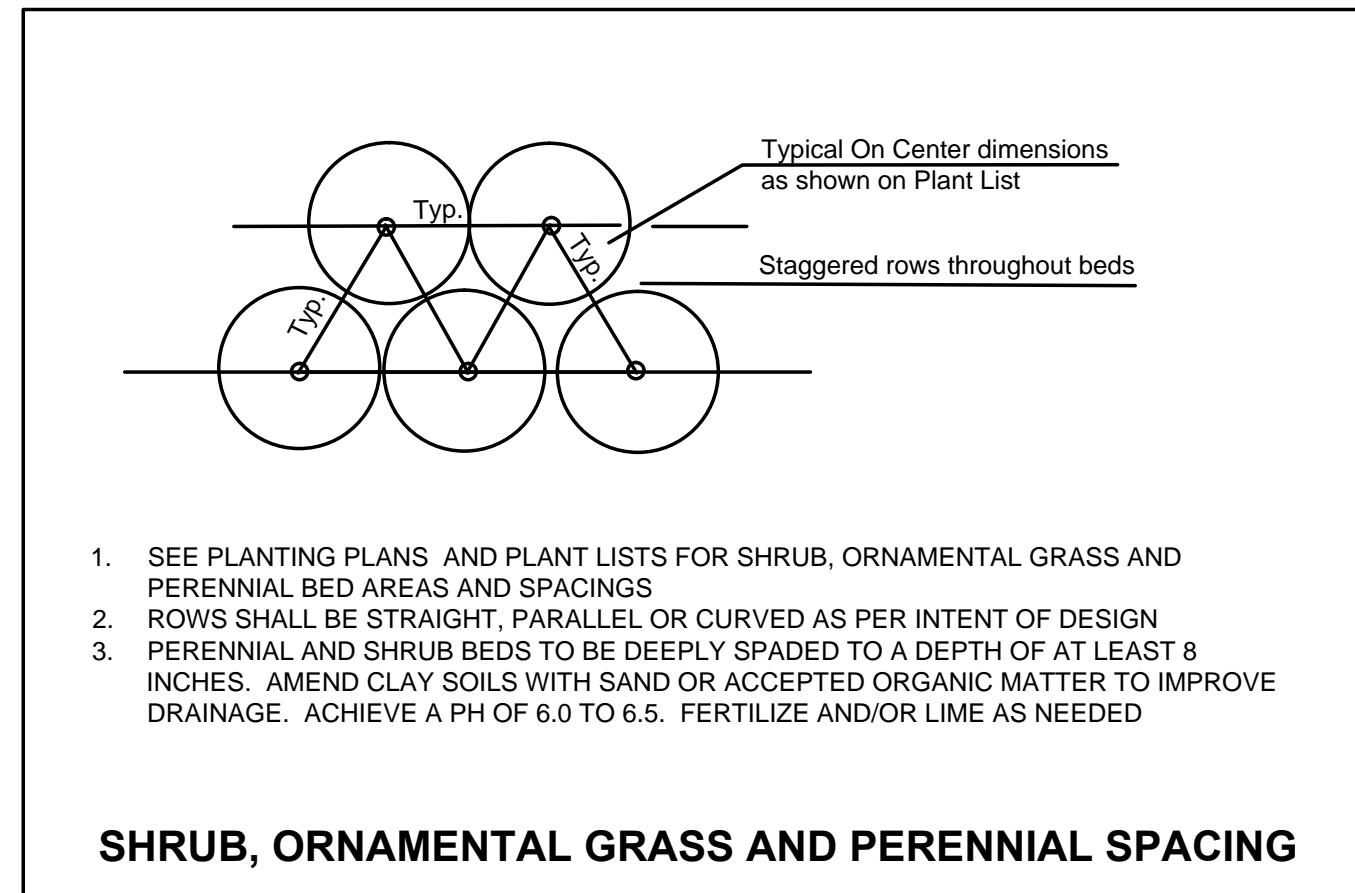
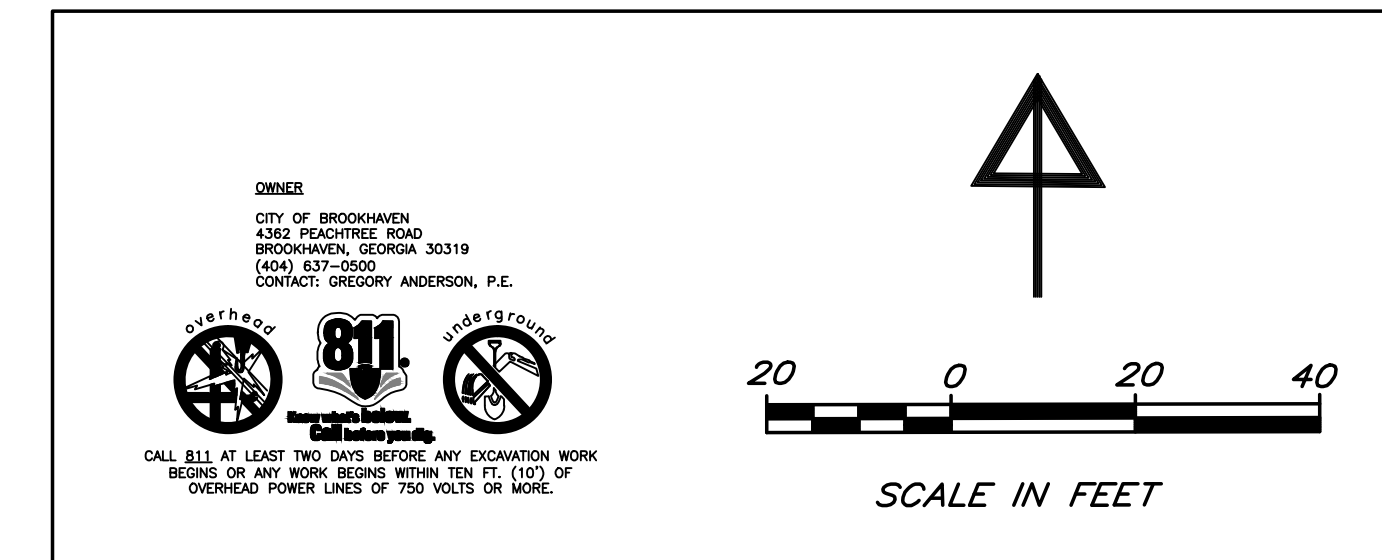

**SHRUB, ORNAMENTAL GRASS AND PERENNIAL SPACING**

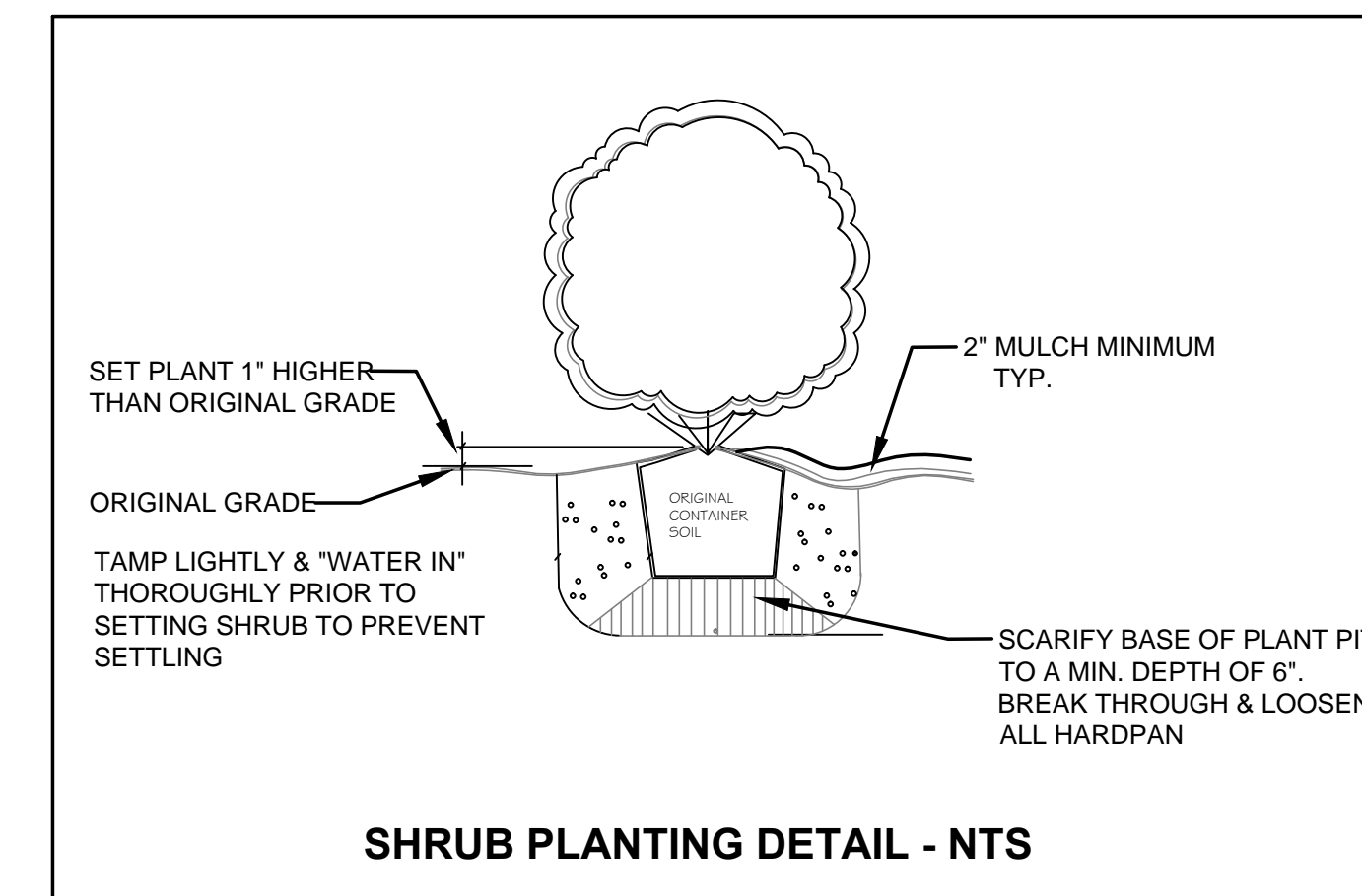

**SHRUB PLANTING DETAIL - NTS**

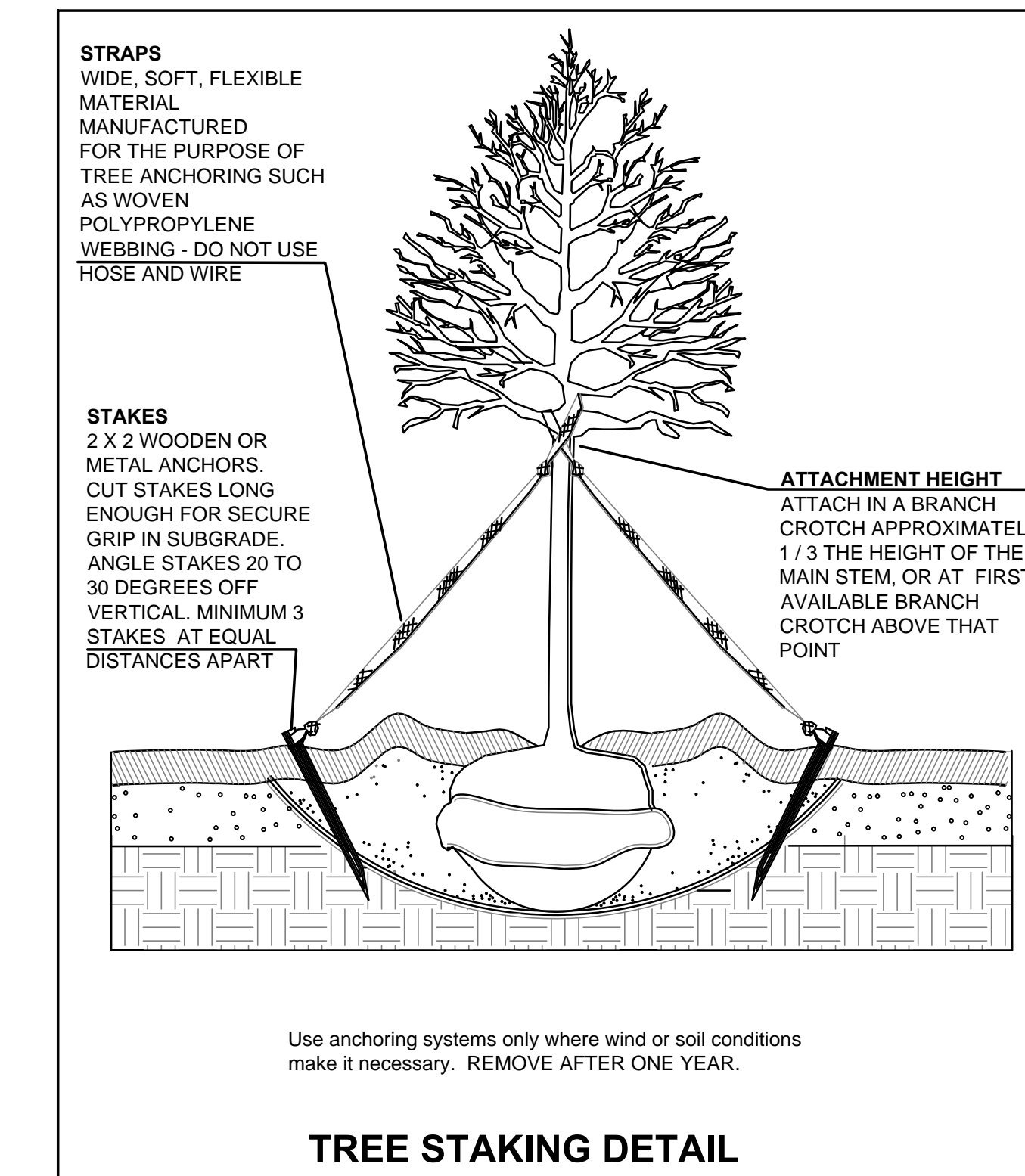

**TREE STAKING DETAIL**

NO.	DATE	REVISION DESCRIPTION	BY	CHKD